

## VRLA Rechargeable Battery

# BPS65-12

### FEATURES

- Maintenance free(no water topping-up required)
- No free acid(Non-spillable battery)
- Can be used in any orientation(excluding used inverted)
- Carry handles for easy installation
- Absorbent Glass Mat technology for efficient gas recombination
- Long life expectancy 10 years in float application

### APPLICATIONS

- UPS
- Golf-Carts
- Telecom



### SPECIFICATIONS

Nominal Voltage	12V	
Nominal Capacity	20 Hour Rate (3.25A, 10.5V)	65.0 Ah
	10 Hour Rate (6.18A, 10.5V)	61.8 Ah
	5 Hour Rate (11.05A, 10.5V)	55.3 Ah
	1 Hour Rate (39.00A, 9.3V)	39.0 Ah
Approx. Weight	22.4Kg(49.38lbs.)	
Terminals	B5 (Fitting M6 bolt & nut) I2 is optional	
Max. Discharge Current	650 A (5 sec.)	
Max. Charge Current	19.5 A	
Operating Temperature Range	Charge	0°C~40°C(32°F~104°F)
	Discharge	-20°C~50°C(-4°F~122°F)
	Storage	-20°C~40°C(-4°F~104°F)
Self Discharge	< 3% per month (25°C)	
Internal Resistance	≤ 5mΩ (Fully Charged )	

### CONTAINER MATERIAL

- Standard: ABS( UL94 HB)  
Model Name: BPS65-12
- Optional: Flame Retardant ABS (UL94 V-0)  
Model Name: BPS65-12FR

Certificate as below:



Compliance of the standards as below:

- IEC 61056-1
- JIS C 8702-1
- GB/T 19639.1

OUTER DIMENSIONS mm(inch)	Length (L)	Width (W)	Container Height (H)	Total Height (TH)
	350±2.0(13.78±0.08)	166±2.0(6.54±0.08)	174±2.0(6.85±0.08)	174±2.0(6.85±0.08)

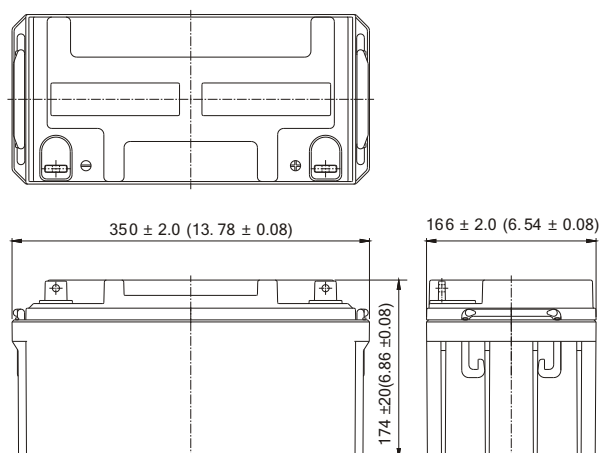

### TERMINAL TYPE

● Terminal B5

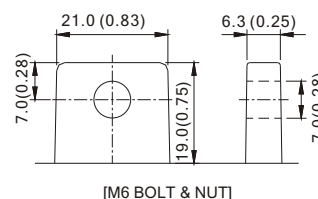

● Terminal I2

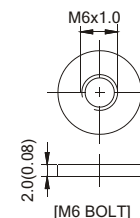

Terminal Hardware Initial Torque: B5,I2(5.5Nm±5%)

**BPS65-12 (BPS65-12FR) discharge characteristics (25°C/77°F)**

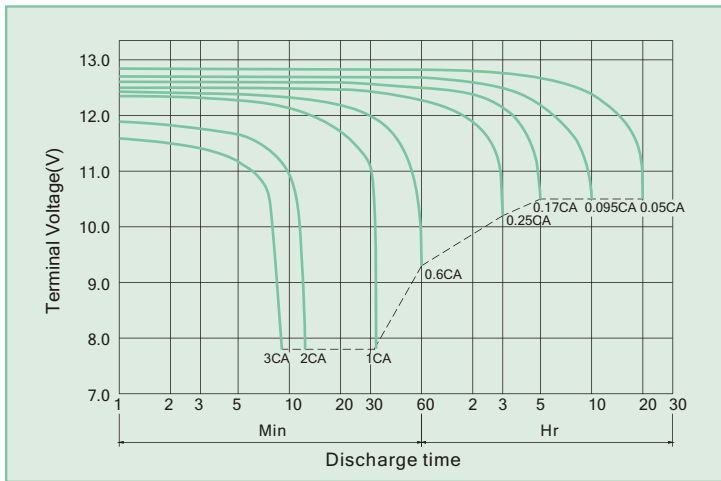

**Battery Charging Characteristics**

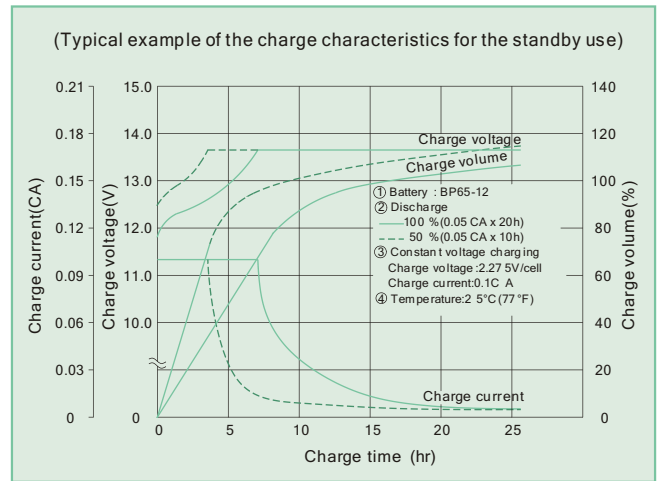

**Charging Procedure**

Application	Charging method	Charging Voltage at 25°C (V/cell)	Temperature compensation coefficient of charging voltage (mV/°C/cell)	Max. charging current (CA)	Charging time 0.1CA, 25°C (h)		Temp (°C)
					100% discharge	50% discharge	
For standby power Source	Constant voltage & Constant current charging (with current restriction)	2.25~2.30	-3	0.3	24	20	0~40 (32~104°F)
For cycle service		2.40~2.50	-4	0.3	16	10	

**Effect Of Temperature On Long Term Float Life**

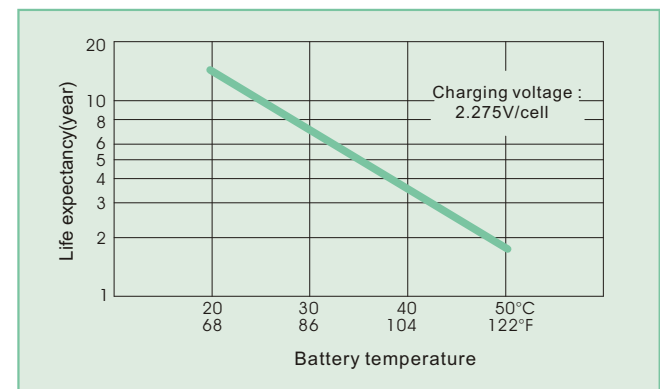

**Constant power discharge characteristics at 25°C/77°F Unit: W**

F.V. (V/cell) \ Discharge Time	5 Min	10 Min	15 Min	30 Min	1 Hr	3 Hr	5 Hr	10 Hr	20 Hr
1.80V	2115	1661	1345	825	509.5	204.0	140.7	78.62	41.37
1.75V	2448	1799	1407	856	524.7	208.1	142.8	79.80	42.00
1.70V	2601	1864	1450	876	534.2	210.0	143.6	80.20	42.21
1.65V	2718	1909	1484	888	540.6	211.5	144.1	80.44	42.34
1.60V	2808	1947	1513	897	546.0	212.7	144.5	80.44	42.34

**Constant current discharge characteristics at 25°C/77°F Unit: A**

F.V. (V/cell) \ Discharge Time	5 Min	10 Min	15 Min	30 Min	1 Hr	3 Hr	5 Hr	10 Hr	20 Hr
1.80V	191	146.2	116.9	69.9	42.81	17.00	11.72	6.55	3.45
1.75V	225	158.4	122.3	72.6	44.10	17.34	11.90	6.65	3.50
1.70V	239	164.1	126.1	74.2	44.89	17.50	11.96	6.68	3.52
1.65V	249	168.0	129.0	75.3	45.43	17.62	12.01	6.70	3.53
1.60V	258	171.4	131.6	76.0	45.88	17.73	12.04	6.70	3.53

All data and artworks shall be changed without prior notice, BB reserves the right to explain and update the information contained hereinto. For operation, please refer to the instruction from technical manual.

A/0 REV. Nov. 2024

<p><b>USA:</b> B&amp;B BATTERY(USA) INC. 6415 RANDOLPH ST.COMMERCE,CA,90040 U.S.A. TEL:1-323-278-1900,1-800-278-8599 FAX:1-323-278-1268 E-Mail:sales@bb-battery.com</p> <p><b>CHINA FACTORY:</b> B.B. TECH(CHANGSHA) CO., LTD. No.57 DongsiRoad, Changsha National Economic &amp; Technical Development Zone, Changsha, Hunan PRC TEL:86-731-82955888 FAX:86-731-82955111 E-Mail:maggy@bb-battery.com</p>	<p><b>EUROPE:</b> B&amp;B BATTERY(EUROPE) B.V. SUITE 8, HAAKSBERGWEG 33, 1101 BP AMSTERDAM,THE NETHERLANDS TEL: 31-30-320-0190 MOBILE: 852-9128-2711 E-Mail: dliu@bb-battery.com</p> <p><b>HONG KONG:</b> B&amp;B BATTERY(Hong Kong) Co. TEL:852-2311-4918 FAX:852-2739-1182 E-Mail:bbhk@hkstar.com</p>	<p><b>JAPAN:</b> B&amp;B BATTERY(JAPAN) CO., LTD. 1375-11 NARAHARA-MACHI,HACHIOJI, TOKYO 193-0803,JAPAN. TEL:81-426-25-6375 FAX:81-426-25-6375 E-Mail:miyata@bb-battery.com</p> <p><b>TAIWAN:</b> B.B. BATTERY(TAIWAN) CO., LTD. TEL:886-6-502-5150 FAX:886-6-589-8087 E-Mail:kevinlin@bb-battery.com</p>
---	---	---