



VRLA Rechargeable Battery

BPL80-12



FEATURES

- Maintenance free(no water topping-up required)
- No free acid(Non-spillable battery)
- Low self-discharge rate
- Can be used in any orientation(excluding used inverted)
- Filtered with explosion proof filter
- Flame-arrestor is installed to ensure safety
- Absorbent Glass Mat technology for efficient gas recombination

APPLICATIONS

- UPS
- Telecom
- Golf-carts



SPECIFICATIONS

Nominal Voltage	12 V
Nominal Capacity	80.0Ah @ 20 hour rate F.V.(1.75V/cell)
Approx. Weight	26.8Kg(59.1lbs.)
Terminals	I2 (M6 Female Thread)
Internal Resistance	≤5.0mΩ (Fully Charged)
Max. Discharge Current	800 A (5 sec.)
Max. Charge Current	24.0 A
Operating Temperature Range	Charge: 0°C~40°C(32°F~104°F) Discharge: -20°C~50°C(-4°F~122°F) Storage: -20°C~40°C(-4°F~104°F)
Container Material	Standard: ABS(UL94 HB) BPL80-12 Optional: Flame Retardant ABS(UL94 V-0) BPL80-12FR

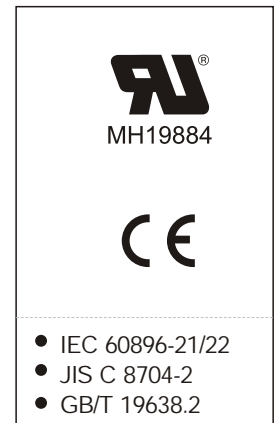

DIMENSION(mm/inch)

OUTER DIMENSIONS

TERMINAL TYPE

- **Length**
260±2.0 (10.24±0.08)
- **Width**
168±2.0 (6.61±0.08)
- **Container Height**
215±2.0 (8.46±0.08)
- **Total Height**
215±2.0 (8.46±0.08)

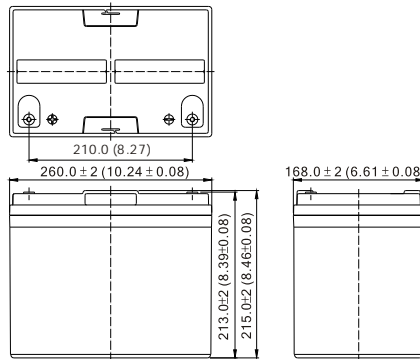

- Terminal I2

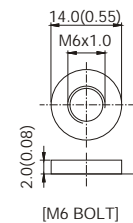

Terminal Hardware Initial Torque: I2 (5.5Nm±5%)

Constant power discharge characteristics at 25 °C/77 °F

Unit: W

Discharge Time F.V. (V/cell)	15 Min	30 Min	1 Hr	3 Hr	5 Hr	10 Hr	20 Hr
1.80V	1443	1011	551.3	232.1	160.9	89.63	46.85
1.75V	1532	1049	568.5	237.0	163.3	90.99	47.94
1.70V	1603	1072	578.3	239.4	163.9	91.48	48.07
1.65V	1658	1075	579.4	239.6	164.3	91.61	48.20
1.60V	1692	1085	585.4	239.8	164.3	91.61	48.20

Constant current discharge characteristics at 25 °C/77 °F

Unit: A

Discharge Time F.V. (V/cell)	15 Min	30 Min	1 Hr	3 Hr	5 Hr	10 Hr	20 Hr
1.80V	130	89.5	46.3	19.3	13.4	7.50	3.90
1.75V	139	92.8	47.8	19.7	13.6	7.60	4.00
1.70V	146	94.9	48.6	20.0	13.7	7.62	4.01
1.65V	151	95.1	48.7	20.0	13.7	7.63	4.02
1.60V	154	96.1	49.2	20.0	13.7	7.63	4.02

All data and artworks shall be changed without prior notice, BB reserves the right to explain and update the information contained hereinto.

For operation, please refer to the instruction from technical manual.

B/2 REV. May, 2021

Powered by B.B. Tech(Changsha) Co., Ltd.