

MAINTENANCE-FREE RECHARGEABLE BATTERY FOR HIGH RATE USE

General Features

- Absorbent Glass Mat (AGM) technology for efficient gas recombination of up to 99% and freedom from electrolyte maintenance or water adding.
- Not restricted for air transport-complies with IATA/ICAO Special Provision A67.
- UL-recognized component.
- Can be mounted in any orientation.
- Computer designed lead, calcium tin alloy grid for high power density.
- Long service life, float or cyclic applications.
- Maintenance-free operation.
- Low self discharge.

Dimensions and Weight

Length(mm / inch)	350 / 13.78
Width(mm / inch)	167 / 6.57
Height(mm / inch)	179 / 7.05
Total Height(mm / inch)	183 / 7.20
Approx. Weight(Kg / lbs)	22.2 / 48.9
Standard Terminal	B ₂
Optional Terminal	I

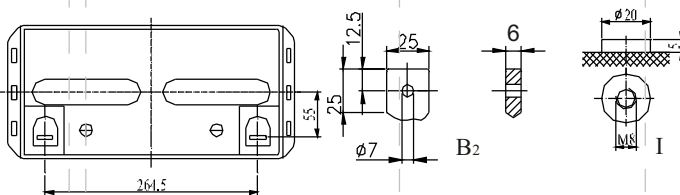
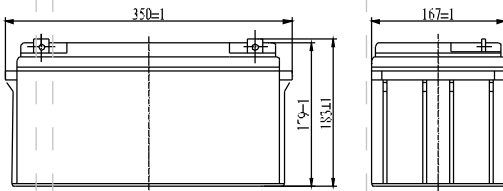

Specification

Nominal Voltage	12V
Number of cell	6
Design Life	10 years
Nominal Capacity 77°F(25°C)	65AH
10 hour rate (6.5A,10.5V)	53.59AH
5 hour rate (10.79A,10.5V)	42.25AH
1 hour rate (42.25A,10.5V)	

Internal Resistance

Fully Charged battery 77°F(25°C) 6mOhms

Self-Discharge

3% of capacity declined per month at 20°C(average)

Operating Temperature Range

Discharge	-20~60°C
Charge	-10~60°C
Storage	-20~60°C

Max. Discharge Current 77°F(25°C)

650A(5s)

Short Circuit Current

1700A

Charge Methods: Constant Voltage Charge 77°F(25°C)

Cycle use	14.4-14.7V
Maximum charging current	19.5A
Temperature compensation	-30mV/°C
Standby use	13.6-13.8V
Temperature compensation	-20mV/°C

Discharge Constant Current (Amperes at 77°F25°C)

End Point Volts/Cell	5min	10min	15min	30min	1h	3h	5h	10h
1.60V	243	174	126	74.9	42.2	16.9	11.1	6.76
1.65V	236	165	124	73.6	42.0	16.8	10.9	6.69
1.70V	223	159	122	72.8	41.6	16.7	10.8	6.63
1.75V	200	147	116	71.1	41.3	16.6	10.7	6.56
1.80V	180	134	107	67.9	40.3	16.2	10.5	6.50

Discharge Constant Power (Watts at 77°F25°C)

End Point Volts/Cell	5min	10min	15min	30min	1h	3h	5h	10h
1.60V	435	317	234	140	80.5	32.6	21.2	12.6
1.65V	426	303	228	138	80.0	32.4	21.1	12.5
1.70V	402	293	225	138	79.5	32.3	20.9	12.4
1.75V	362	271	215	133	78.6	32.1	20.8	12.3
1.80V	325	246	198	127	76.6	31.3	20.6	12.2

Discharge characteristic (25°C)

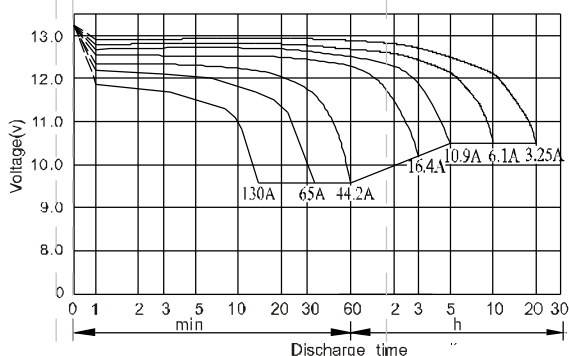

Constant voltage charging characteristic (0.25CA, 25°C)

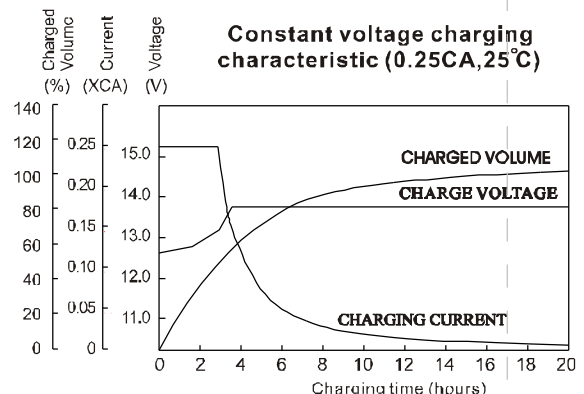

MAINTENANCE-FREE RECHARGEABLE BATTERY FOR HIGH RATE USE

