

VRLA Rechargeable Battery

EP75-12

FEATURES

- Absorbent Glass Mat technology for efficient gas recombination
- Maintenance free(no water topping-up required)
- No free acid(Non-spillable battery)
- Can be used in any orientation(excluding used inverted)
- The battery is designed for heavy duty cyclic application
- Flame-arrestor is installed to ensure safety
- Its design life is approx.400 cycles at 100% discharge in cycle service at 77°F/25°C

APPLICATION

- UPS
- Telecom
- EV
- Golf-carts

SPECIFICATIONS

Nominal Voltage	12V	
Nominal Capacity	20 Hour Rate (3.75A, 10.5V)	75.0 Ah
	10 Hour Rate (7.13A, 10.5V)	71.3 Ah
	5 Hour Rate (12.75A, 10.5V)	63.8 Ah
	30 Min Rate (75.0A, 7.8V)	37.5 Ah
Approx. Weight	26.8Kg(59.1lbs.)	
Terminals	I2 (M6 Female Thread)	
Max. Discharge Current	750 A (5 sec.)	
Max. Charge Current	22.5 A	
Operating Temperature Range	Charge	0°C~40°C(32°F~104°F)
	Discharge	-20°C~50°C(-4°F~122°F)
	Storage	-20°C~40°C(-4°F~104°F)
Self Discharge	< 3% per month (25°C)	
Internal Resistance	≤ 5mΩ (Fully Charged)	



CONTAINER MATERIAL

- Standard: ABS(UL 94-HB)
Model Name: EP75-12
- Optional: Flame Retardant ABS (UL 94-V0)
Model Name: EP75-12FR

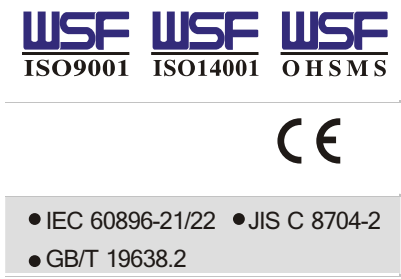

OUTER DIMENSIONS mm(inch)

Length (L)	Width (W)	Container Height (H)	Total Height (TH)
260±2.0(10.24±0.08)	168±2.0(6.61±0.08)	215±2.0(8.46±0.08)	215±2.0(8.46±0.08)

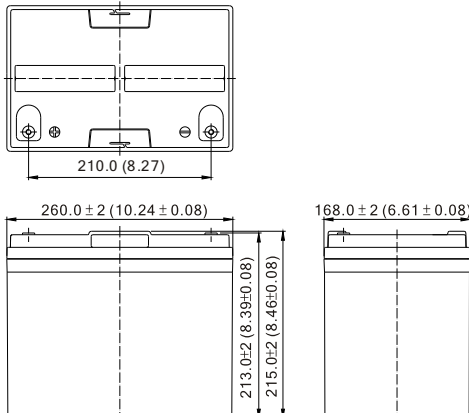

TERMINAL TYPE

- Terminal I2

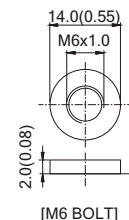

Terminal Hardware Initial Torque: I2(5.5Nm±5%)

EP75-12 (EP75-12FR) discharge characteristics (25°C/77°F)

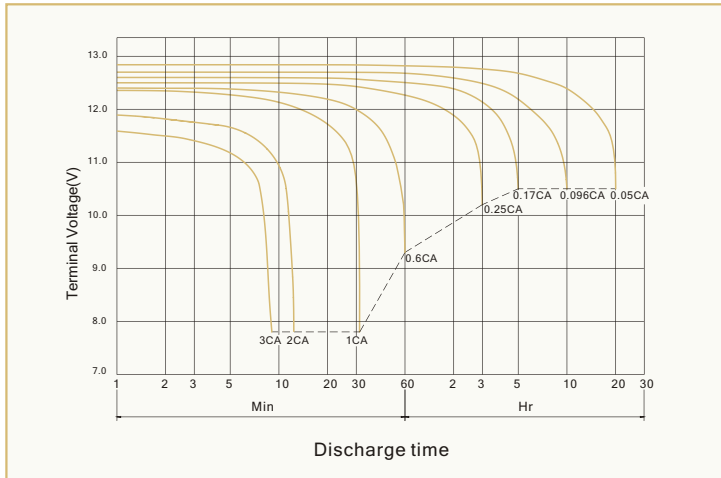

Battery Charging Characteristics

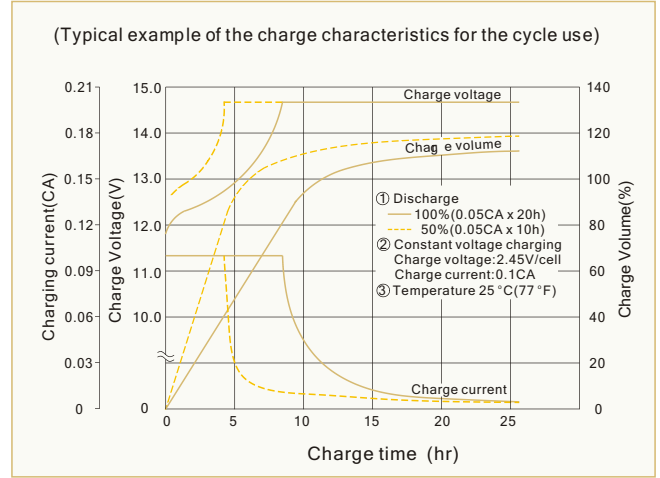

Charging Procedure

Application	Charging method	Charging Voltage at 25°C (V/cell)	Temperature compensation coefficient of charging voltage (mV/°C/cell)	Max. charging current (CA)	Charging time 0.1CA, 25°C (h)		Temp (°C)
					100% discharge	50% discharge	
For standby power source	Constant voltage & Constant current charging (with current restriction)	2.25~2.30	-3	0.3	24	20	0~40 (32~104°F)
For cycle service		2.40~2.50	-4	0.3	16	10	

Battery Life Characteristics of Cyclic Use

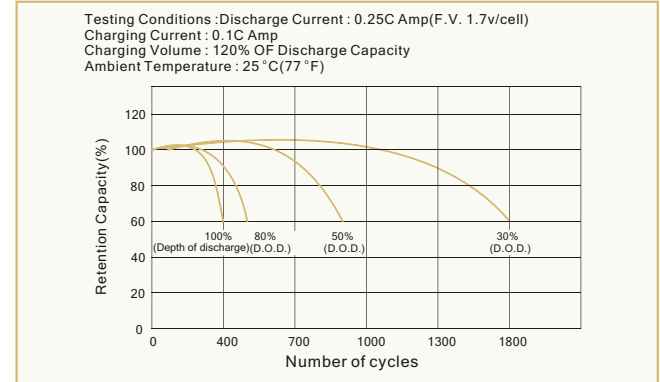

Constant power discharge characteristics at 25°C/77°F Unit: W

F.V. (V/cell) \ Discharge Time	15 Min	30 Min	1 Hr	3 Hr	5 Hr	10 Hr	20 Hr
1.80V	1353	948	517	218	151	84.0	43.9
1.75V	1436	983	533	222	153	85.3	44.9
1.70V	1503	1005	542	224	154	85.8	45.1
1.65V	1554	1008	543	225	154	85.9	45.2
1.60V	1586	1018	549	225	154	85.9	45.2

Constant current discharge characteristics at 25°C/77°F Unit: A

F.V. (V/cell) \ Discharge Time	15 Min	30 Min	1 Hr	3 Hr	5 Hr	10 Hr	20 Hr
1.80V	122	83.9	43.6	18.2	12.56	7.02	3.67
1.75V	130	87.0	44.8	18.6	12.75	7.13	3.75
1.70V	137	89.0	45.7	18.8	12.84	7.16	3.77
1.65V	142	89.2	46.3	18.9	12.94	7.18	3.78
1.60V	144	90.1	46.7	19.0	12.94	7.18	3.78

All data and artworks shall be changed without prior notice, BB reserves the right to explain and update the information contained herein.

For operation, please refer to the instruction from technical manual.

Trial A/0 REV. Apr. 2015

<p>USA: B&B BATTERY(USA) INC. 6415 RANDOLPH ST.COMMERCE, CA,90040 U.S.A. TEL:1-323-278-1900.1-800-278-8599 FAX:1-323-278-1268 E-Mail:sales@bb-battery.com</p> <p>CHINA FACTORY: B. B. BATTERY CO., LTD. CHENG DONG TRIAL AREA,HUANG GANG, RAOPING, GUANG DONG,CHINA,515700 TEL:86-768-7601001-2 FAX:86-768-7601469 E-Mail:maggy@bb-battery.com</p>	<p>EUROPE: B&B BATTERY(EUROPE) B.V. SUITE 8, HAAKSBERGWEG 33, 1101 BP AMSTERDAM, THE NETHERLANDS TEL: 31-30-320-0190 MOBILE: 852-9128-2711 E-Mail: dliu@bb-battery.com</p> <p>HONG KONG: B&B BATTERY(Hong Kong) Co. TEL:852-2311-4918 FAX:852-2739-1182 E-Mail:bbhk@hkstar.com</p>	<p>JAPAN: B&B BATTERY(JAPAN) CO., LTD. 1375-11 NARAHARA-MACHI,HACHIOJI, TOKYO 193-0803,JAPAN. TEL:81-426-25-6375 FAX:81-426-25-6375 E-Mail:miyata@bb-battery.com</p> <p>TAIWAN: B. B. BATTERY(TAIWAN) CO., LTD. TEL:886-6-502-5150 FAX:886-6-589-8087 E-Mail:kevinlin@bb-battery.com</p>
--	--	--